

22.2 Outdoor Unit

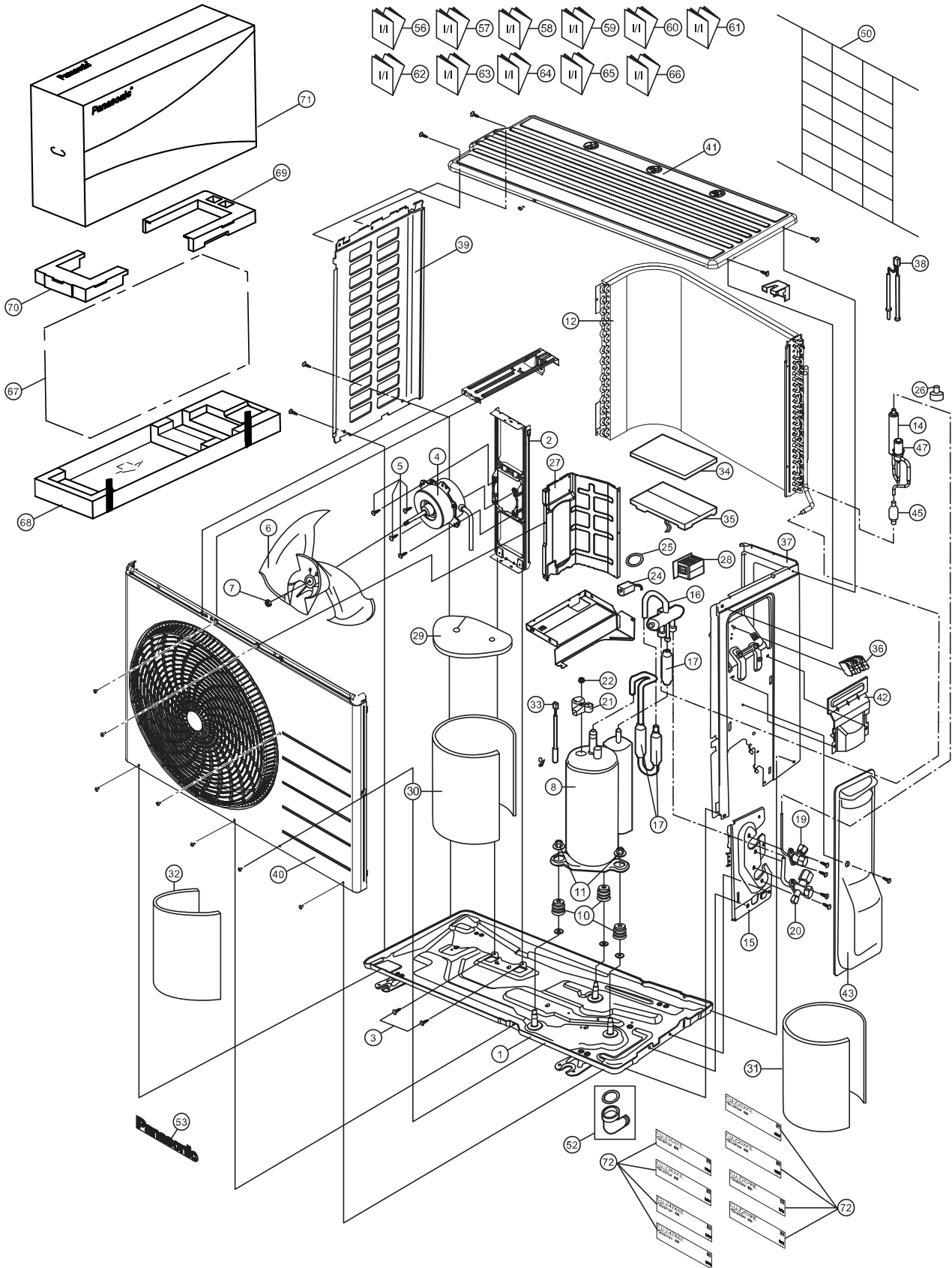

Note
The above exploded view is for the purpose of parts disassembly and replacement.
The non-numbered parts are not kept as standard service parts.

SAFETY	REF. NO.	PART NAME & DESCRIPTION	QTY.	CU-Z35XKE	CU-Z42XKE	REMARK
	1	CHASSIS COMPLETE	1	CWD52K1399	←	
	2	FAN MOTOR BRACKET	1	CWD541157	←	
	3	SCREW - FAN MOTOR BRACKET	2	ACXH55-07140	←	
⚠	4	FAN MOTOR	1	L6CAYYYL0083	←	0
	5	SCREW - FAN MOTOR MOUNT	4	CWH55252J	←	
	6	PROPELLER FAN ASSY	1	CWH03K1100	←	
	7	NUT - PROPELLER FAN	1	CWH56053J	←	
⚠	8	COMPRESSOR	1	9RS102XRA21	←	0
	10	ANTI - VIBRATION BUSHING	3	CWH50077	←	
	11	NUT - COMPRESSOR MOUNT	3	CWH561096	←	
	12	CONDENSER	1	ACXB32C23130	←	
	14	DISCHARGE MUFFLER	1	CWB121021	←	
	15	HOLDER COUPLING	1	CWH351233	←	
	16	4-WAYS VALVE	1	ACXB00-01290	←	
	17	DISCHARGE MUFFLER(4 W.VALVE)	1	CWB121010	←	
	19	2-WAYS VALVE (LIQUID)	1	ACXB02-03310	←	
	20	3-WAY VALVE (GAS)	1	ACXB01-04540	ACXB01-02280	
	21	TERMINAL COVER	1	CWH171039A	←	
	22	NUT - TERMINAL COVER	1	CWH7080300J	←	
⚠	24	V-COIL COMPLETE - 4 WAY VALVE	1	ACXA43C00250	←	0
	25	O-RING	1	ACXB81-06510	←	
⚠	26	V-COIL COMPLETE - EXP.VALVE	1	ACXA43C06110	←	0
	27	SOUND PROOF BOARD	1	CWH151428	←	
⚠	28	REACTOR	1	G0C392J00037	G0C392J00050	0
	29	SOUND PROOF MATERIAL - TOP	1	CWG302314	←	
	30	SOUND PROOF MATERIAL - COMP. BODY	1	ACXG30-11540	←	
	31	SOUND PROOF MATERIAL	1	ACXG30-11800	←	
	32	SOUND PROOF MATERIAL	1	CWG302994	←	
⚠	33	SENSOR CO-COMP TEMP	1	ACXA50C17380	←	0
	34	CONTROL BOARD COVER-TOP	1	ACXH13-00450	←	
⚠	35	ELECTRONIC CONTROLLER - MAIN	1	ACXA73C72830R	ACXA73C72840R	0
	36	TERMINAL BOARD ASSY	1	CWA28K1298	←	
	37	CABINET SIDE PLATE CO.	1	ACXE04C00460	←	
⚠	38	SENSOR CO-AIR TEMP AND PIPE TEMP	1	CWA50C3079	←	0
	39	CABINET SIDE PLATE	1	CWE041858A	←	
	40	CABINET FRONT PLATE CO.	1	CWE06C1566	←	
	41	CABINET TOP PLATE	1	CWE031230A	←	
	42	PLATE - C. B. COVER TERMINAL	1	CWH131301	←	
	43	CONTROL BOARD COVER CO.	1	CWH13C1359	←	
	45	STRAINER	1	CWB11094	←	
	47	EXPANSION VALVE	1	ACXB05-01080	←	
	50	WIRE NET	1	ACXD04-00040A	←	
	52	BAG-COMPLETE	1	CWG87C900	←	
	53	PANASONIC BADGE	1	CWE373439	←	
	56	INSTALLATION INSTRUCTION	1	ACXF60-42621	←	
	57	INSTALLATION INSTRUCTION	1	ACXF60-42631	←	
	58	INSTALLATION INSTRUCTION	1	ACXF60-42641	←	

SAFETY	REF. NO.	PART NAME & DESCRIPTION	QTY.	CU-Z35XKE	CU-Z42XKE	REMARK
	59	INSTALLATION INSTRUCTION	1	ACXF60-42651	←	
	60	INSTALLATION INSTRUCTION	1	ACXF60-42661	←	
	61	INSTALLATION INSTRUCTION	1	ACXF60-42671	←	
	62	INSTALLATION INSTRUCTION	1	ACXF60-42681	←	
	63	INSTALLATION INSTRUCTION	1	ACXF60-42691	←	
	64	INSTALLATION INSTRUCTION	1	ACXF60-42701	←	
	65	INSTALLATION INSTRUCTION	1	ACXF60-42711	←	
	66	INSTALLATION INSTRUCTION	1	ACXF60-42721	←	
	67	BAG	1	CWG861078	←	
	68	BASE BOARD-COMPLETE	1	CWG62C1223	←	
	69	SHOCK ABSORBER - RIGHT	1	CWG713778	←	
	70	SHOCK ABSORBER - LEFT	1	CWG713779	←	
	71	C.C.CASE	1	ACXG50-48861	←	
	72	MODEL LABEL	2	ACXF85-62790	ACXF85-62800	

(NOTE)

- All parts are supplied from PAPAMY, Malaysia (Vendor Code: 00029488).
- "O" marked parts are recommended to be kept in stock.